

TACT switch

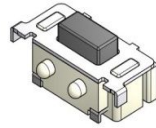

TSTA type

TSTA07 Series



(size : 7.0×3.5×3.5) Side push Surface mount type

T
S
T

■ Features

- Surface mount type tact switch.
- Reflow solderable.
- Horizontal operating direction.

■ Applications

- Various controls for devices in automotive.
- Portable audio devices, Personal digital assistant.
- Operating signal input switches, etc.

■ Main Specifications

Rating	50mA 12V DC
Travel	0.25±0.1mm
Contact Resistance	100mΩ Max
Operating temperature	-20°C~70°C (45%~85% RH)
Bounce	10m sec Max
Operating Force	160±40gf 250±60gf
Operating Life(Cycle)	50,000 30,000

■ Products Line

TSTA07 -
 (Products No.) (O/F)

Products No.	O/F	O/D	Body guide Boss	Drawing No
DFOWA	<input type="checkbox"/> <input type="checkbox"/>	Horizontal	With	1
DFWWA	<input type="checkbox"/> <input type="checkbox"/>		With-out	2

Operating Force	<input type="checkbox"/> <input type="checkbox"/>	160±40gf	16	250±60gf	25
-----------------	---	----------	-----------	----------	-----------

■ Dimensions

TSTA07-□□□□□ □□

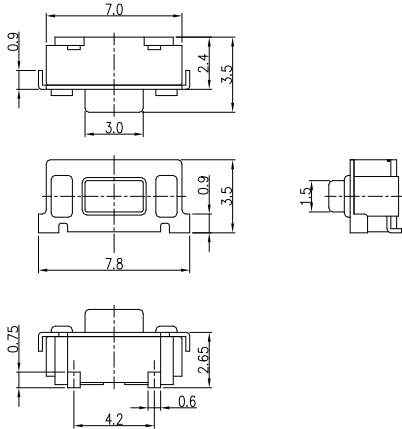
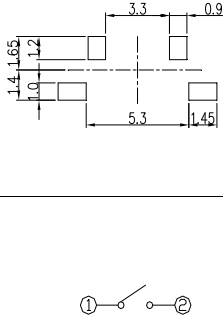
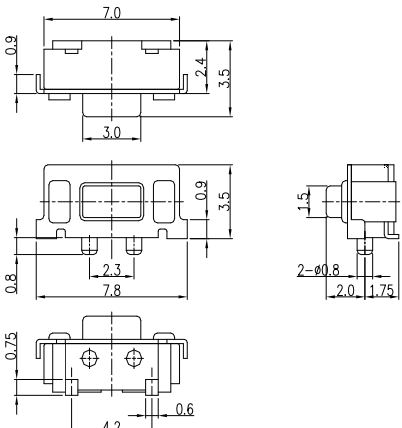
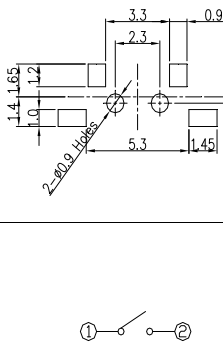
No.	3D Style	Dimension Type (Unit : mm)	PCB pattern dimension Circuit Diagram
1	DFOWA □□		
2	DFWWA □□		

T
S
T